

MANITOBA INSTITUTE OF
TRADES & TECHNOLOGY



WELCOME TO
PTEC
INFORMATION
NIGHT

TEAM PTEC

How PTEC/PTC, MITT and TechMB work together in
Grade 11



Welcome to grade 11!
MITT is waiting for you.

Traditional Territories Acknowledgement Statement

The Manitoba Institute of Trades and Technology acknowledges that it is situated on **Treaty 1 territory** and the traditional territory of Anishinaabeg, Cree, Dakota, and Dene Peoples, and the homeland of the Métis Nation

<https://www.youtube.com/watch?v=MhyKEtRG6Gk>

Jared Enns

Academic Coordinator - MITT

Jane Bachart

Principal - PTEC

PTEC is an accelerated, highly technical program with a commitment to current, and industry-driven curriculum.

We believe in quality outcomes, and high expectations, and value hard work.

That is why we continue to be recognized by other school divisions across Canada, industry members, Government, and professionals for our exemplary work with students and our continued relationship with industry.

PARTNERS

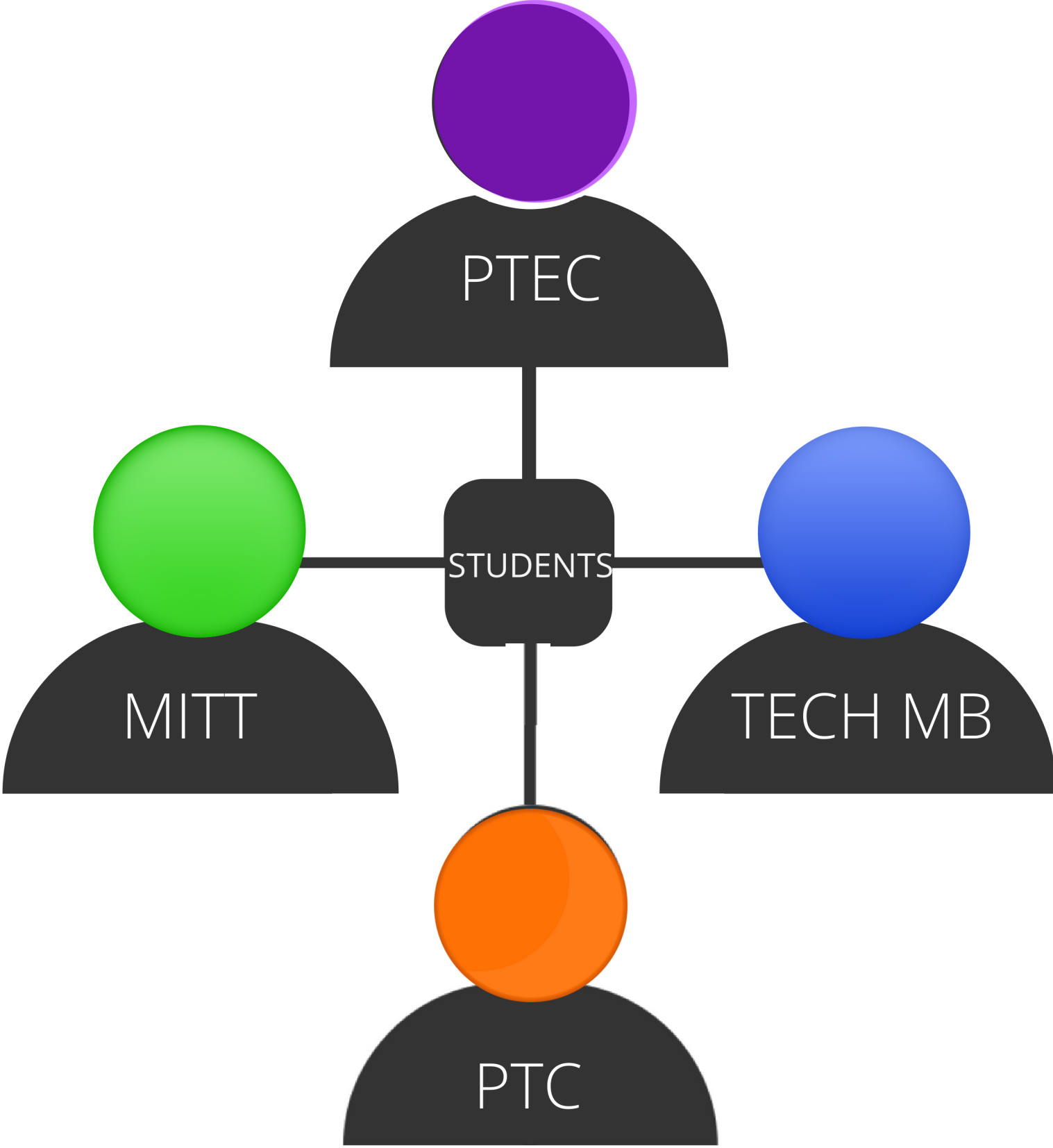

CONTACTS

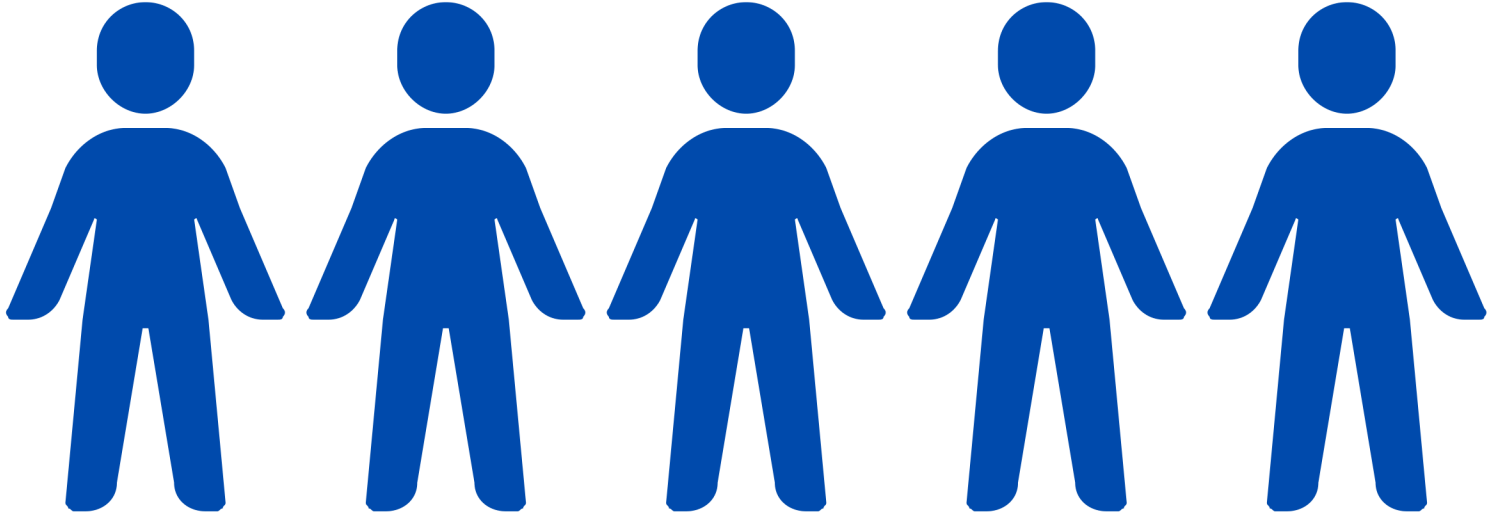

MITT

- Instructors
- Jared Enns
- Tarek Abdel-Aziz

PTC

- Lana Francis
- Jane Bachart
- Jacqui Kroeker

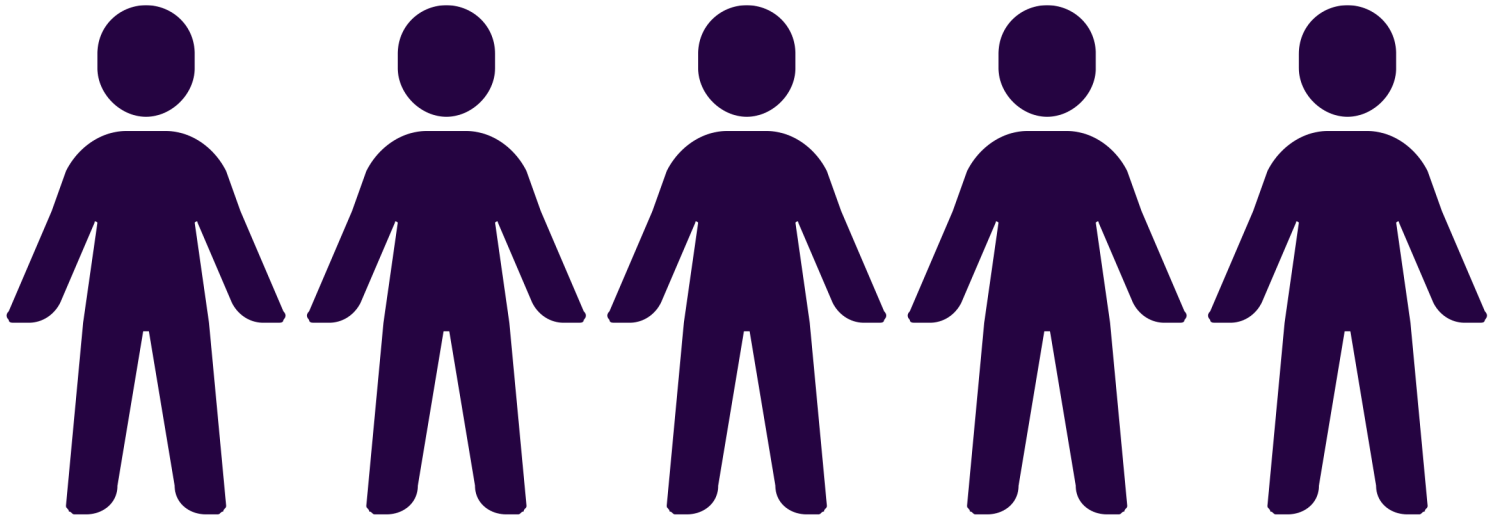

PEMBINA TRAILS COLLEGIATE

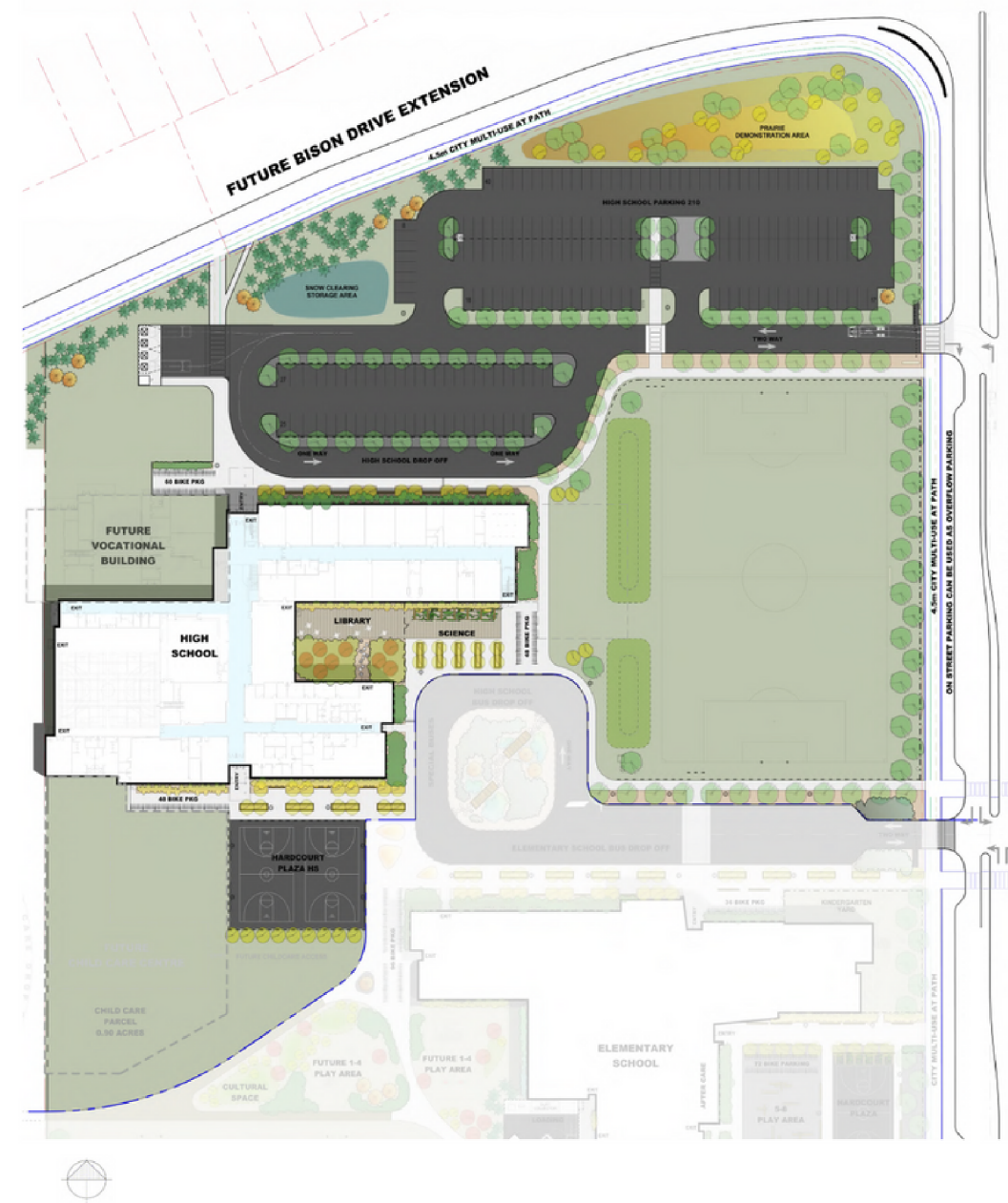

Students will take **FOUR** of their compulsory courses at PTC:

- History
- ELA
- Math
- PE
- and possibly two other courses that will alleviate the pressure on their grade 12 timetable or Sciences/Maths



Timetables will be GIVEN OUT on

- Wednesday, June 21
- Thursday, June 22 at SmartPark with Lana Francis

Timetables CHANGES will be on

- Monday, June 26
- Wednesday, June 28 at SmartPark with Lana Francis

TimeTables

Course requests are requests

Post - secondary



Grade 11

Students will attend PTC in morning and MITT in the afternoon for their first year of College in either **Full Stack Developer** or **Cloud & Network Technician**



Grade 12

Students will attend MITT in the morning and their PTC in the afternoon. They will graduate with not only a **high school diploma** but also a **post-secondary certificate** in the stream of their choice

What does it mean to be a PTEC/PTC/MITT student?

Expectations and realizations

You will be taking all of your compulsory courses at PTC

You will want to prepare for any type of post-secondary education that might take place after MITT.

Planning for entrance requirements for University or scholarships and courses is something that needs to be done now.

You are now a post-secondary student while still at high school

Yes, things will be different. You now have the responsibility of being in post-secondary which means that there are different criteria, expectations, and realizations that will need to be adjusted in your life

Your ability to have multiple option courses including Sciences may not be possible.

We work hard at PTC to attempt to get every course you need in the time slot that you need it in, but as you know, teacher availability, course options, and time slots may not be an option.

Your device

We do not supply you with a divisional device moving into grade 11 for multiple reasons.

MITT will discuss the specs for a new device

Lates, no-shows, absences, academic integrity

You are now not only a Pembina Trails student but also a MITT student.

Requirements and expectations from both schools may vary.



Attendance 100%



No more than three absences

Sometimes students need to be away from school. We understand that. Attendance impedes the success of our students



Family Vacations

Any type of vacation must be discussed with the school. Missing a significant amount of time learning does not support student success



Sign in to
Pembina Trails

Edsby & MITT – Student Portal / MyLearning

It is highly recommended that students are continuously sharing with family members their assignments, tests, and project due dates. With the technology that we have, surprising marks or missing assignments should no longer exist

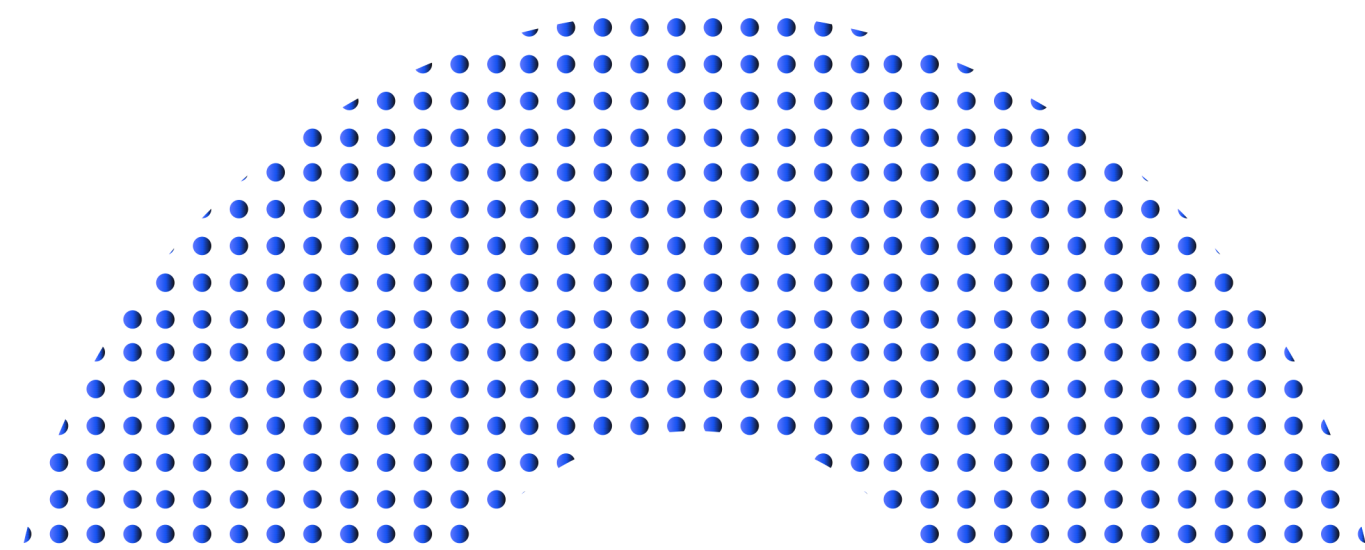

DIVISIONAL TRANSPORTATION



OP-SH-PTC - AM - 7:45 am

PTC - MITT - NOON

MITT - SH - OP - 3:30 pm

Conversations to have with your child.

- Are you ready to put even more time and energy into your schoolwork?
- Are you committed to continuing with MITT?
- Are you prepared to work on assignments and projects outside of MITT class time?
- Every year there will be an assessment of learning and behaviour

Ms. Marie Hacault

Youth-Industry Engagement Program Manager
Tech Manitoba

TECHMB 

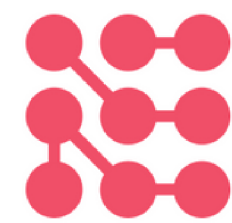

build connections

Empowering Manitoba's
Tech Sector



Marie Hacault
Youth–Industry Engagement Program Manager
Tech Manitoba

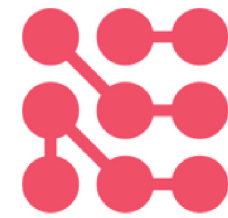

build connections

Empowering Manitoba's
Tech Sector



Who we are:

- ❑ Tech Manitoba represents Manitoba's growing tech sector.
- ❑ We are an industry-led association that helps companies thrive and grow through collaboration, education, and promotion
- ❑ Tech Manitoba leverages 100 corporate members

TECHMB 

SOME OF OUR MEMBERS!



BUSINESS
IT SOLUTIONS
PROVIDER



UBISOFT



COMPUGÉN



NTT DATA



Grade 11 Mentorship Program

- Tech Resume Building (both streams)
- LinkedIn awareness (both streams)
- Code Reviews (SD only)
- Network Design Reviews (NSA)



Marie Hacault
Youth–Industry Engagement Program Manager
Tech Manitoba

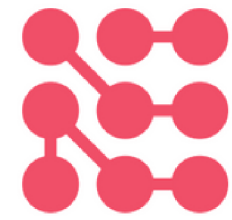

build connections

Empowering Manitoba's
Tech Sector

Mr. Jared Enns

Academic Coordinator - PTEC

Manitoba Institute of Trades and Technology



MANITOBA INSTITUTE OF
TRADES & TECHNOLOGY



PTEC Pathways

Updates and Options

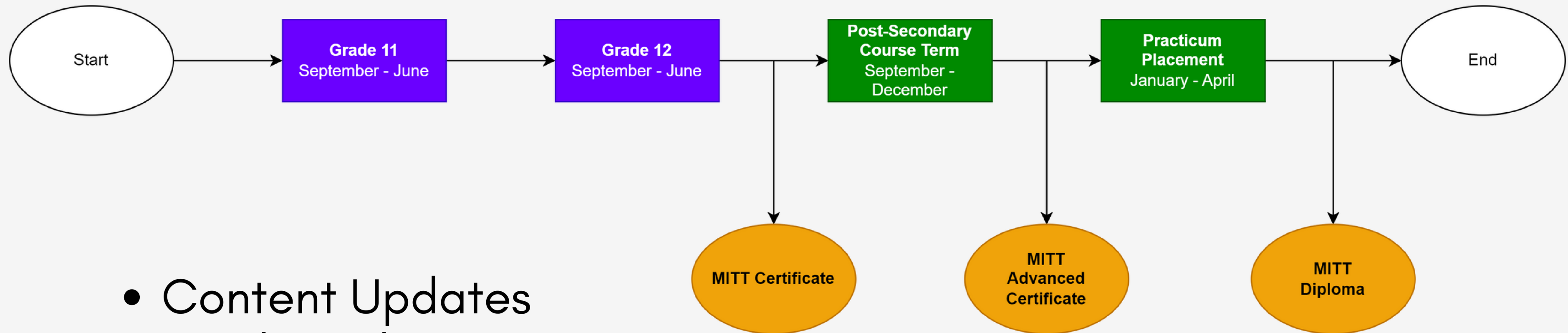

- Content Updates
- Credential Equity
- More Flexibility

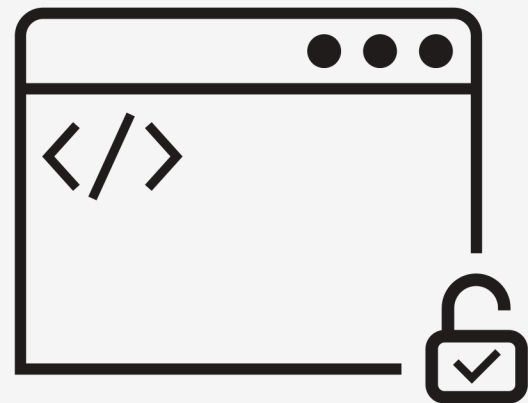

Full-Stack Developer Stream

1. **Intro Prog 1: Programmatic Logic**
2. **Intro to Web Development**
3. **Intro Prog 2: JavaScript**
4. **Intro Prog 3: C# and .Net**
5. **Algorithms and Data Structures**
6. **Relational Database Design**

Instructor: Chris MacDonald⁺

Instructor: Tavaré Tulloch⁺

1. **Intro to Computer Systems**
2. **Networking and IT Essentials**
3. **Intro to Programming in Python**
4. **MS Azure Fundamentals**
5. **MS Azure Administration**

Cloud and Network
Technician Stream

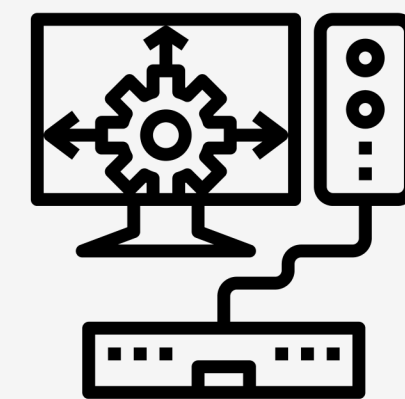

Grade 11 Courses @ MITT

System Requirements and Supplies

- Textbooks are **provided by MITT** for high school
- Laptops are **required**
- PS: Tuition + Supplies + Fees are **student responsibility**



Policies and Procedures

Student Behaviour

Attendance Policy

Academic Integrity

Academic Standards Policy.

Classroom Expectations

- Participate in Discussions
- Learn from each other
- Be willing to try new concepts
- Time Management
- Practice – Practice – Practice
- Have fun with the technology



Pathways and Progression

- MITT is **program-based**
- Progression is **linear**
- Students must **successfully complete each course** to progress to the next

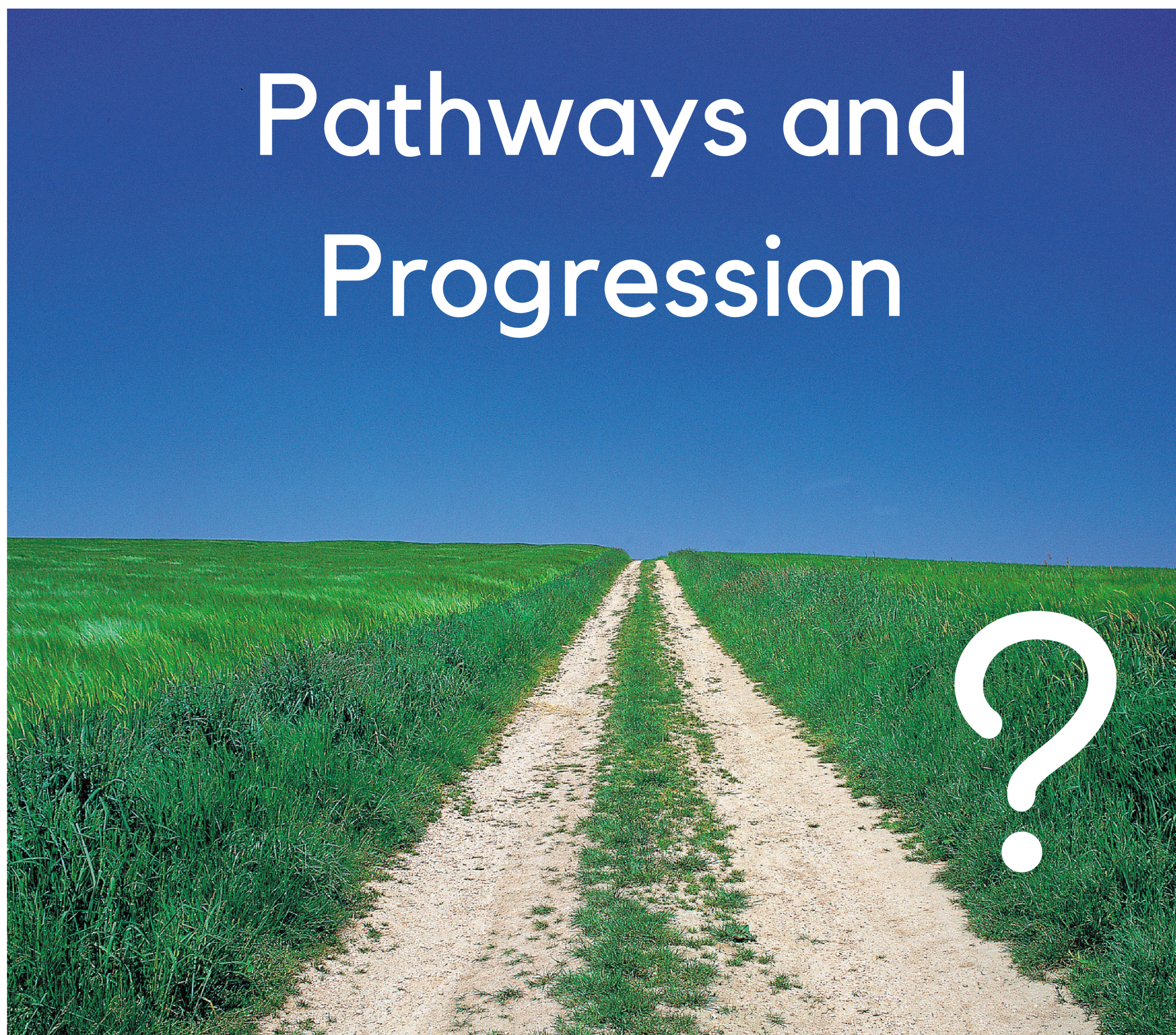

What are dual credits?

Post-secondary courses that students are enrolled in while they are attending high school.

Upon the successful completion of a **dual-credit** course, a student earns a **post-secondary credit** that also counts towards fulfilling the credit requirements for **high school graduation**.

The PS mark or % resides on the PS transcript. The high school transcript will show an 'S' for special credit.

This is what you can expect to see on your high school transcript:

Grade: 11

BIO30S - BIOLOGY 30S	0124(30S)	92	1.0
CH30S - CHEMISTRY 30S	0122(30S)	93	1.0
CS30SPT - COMPUTER SCIENCE (PTEC) 30SPT	0280(30S)	91	1.0
DCA35SPT - DATA ANALYSIS (PTEC) 35SPT	0235(35S)	100	0.5
HIS30F - HISTORY: CANADIAN 30F	0105(30F)	94	1.0
IM35SPT - INTERACTIVE MEDIA (PTEC) 35SPT	0237(35S)	91	0.5
INTAPI32CPT - INTRO TO THIRD-PARTY API (PTEC) 32CPT	4034(32C)	S	0.5
INTDEV32CPT - INTRO TO WEB DEVELOPMENT (PTEC) 32CPT	4031(32C)	S	0.5
IW35S - INTERACTIVE WEBSITE 35S	0225(35S)	86	0.5
JAVASB32CPT - JAVASCRIPT BASICS (PTEC) 32CPT	4032(32C)	S	1.0
MOD35SPT - 3-D MODELLING (PTEC) 35SPT	0236(35S)	91	0.5
OOJ32CPT - OBJECT ORIENTED JAVASCRIPT (PTEC) 32CPT	4033(32C)	S	0.5
PE30F - PHYSICAL EDUCATION/HEALTH 30F	0169(30F)	CO	1.0
RD35SPT - RATIONAL DATA (PTEC) 35SPT	0221(35S)	100	0.5
TECHWRI32CPT - TECHNICAL WRITING SKILLS (PTEC) 32CPT	4035(32C)	S	0.5
WD35S - WEB DESIGN 35S	0234(35S)	86	0.5

INTAPI32CPT - INTRO TO THIRD-PARTY API (PTEC) 32CPT	4034(32C)	S	0.5
INTDEV32CPT - INTRO TO WEB DEVELOPMENT (PTEC) 32CPT	4031(32C)	S	0.5

This is what you can expect to see on your MITT progress reports:

5/14/2021

STUDENT PROGRESS REPORT

Student Name:

Student ID:

Address:

Program Software Developer

FALL + SPRING

GPA Grouping: Secondary 1

2020-2021 College : Manitoba Institute of Trades and Technology - Winnipeg, MB

Course	Course Name	Credits	Midterm	(%)	Final	(%)	Repeat
SD 100	Introduction to Web Development	1.00			A+	97	No
SD 105	Introduction to Third-Party API's	0.50				-	No
SD 110	Javascript Basics	1.00			A+	98	No
SD 120	Object Oriented Javascript	1.00			A+	100	No
SD 130	Tools and Automation	1.00				-	No
SD 160	Technical Writing Skills	1.00			A+	94	No
SD 260	Introduction to React	1.00				-	No
		Attempted	Earned	GPA Hours	Grade Points	GPA	
Term :		6.50	4.00	4.00	18.00	4.5	
Cumulative :		6.50	4.00	4.00	18.00	4.5	

Transcripts + Post-Secondary

Graduating PTEC students have completed a **post-secondary program**



Admissions at other post-secondary institutions may:

- require **official MTT transcripts**
- admit students with **previous post-secondary education** via a different category, (e.g., Advanced Entry at UManitoba)

Transcripts:

- are sent to all students upon graduation
- may be ordered on-demand at any time via our website

Contact us

For inquiries and connecting

PTEC General Phone Number

(204) 560 1999

PTEC Email Addresses

jared.enns@mitt.ca

ptec@pembinatrails.ca

